

80/20® Inc.The *Industrial Erector Set®***THE STANDARD****Roll-In T-Nuts with Set Screw**

- Easy to add and reposition to an existing frame where T-slot ends are captivated
- Can be loaded from the profile end or the profile side
- The set screw permanently positions the T-nut in the T-slot*
- Available in black and bright zinc as well as stainless steel
- Refer to pages 249-259 for our full screw and bolt offering

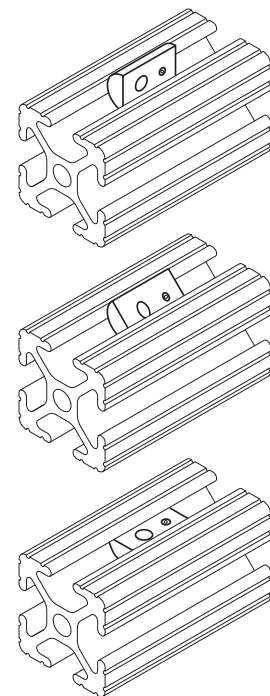

*Note: An "L" wrench or a Bondhus® Combo Tool, shown in Section 11, is required for adjusting the set screw.

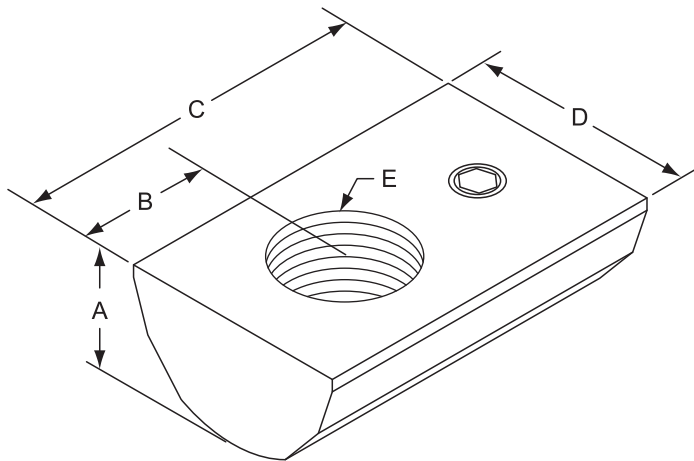

3

Part No.	A	(B) Tap Location	C	D	E (Thread)	Set Screw Thread	Hex Wrench Size	Finish	Lbs.
3312 ☒	.200	.201	.620	.395	10-32	6-32	1/16	Black Zinc	.008
3313 ☒	.200	.201	.620	.395	1/4-20	6-32	1/16	Black Zinc	.008
3309	.285	.310	.875	.510	10-32	10-24	3/32	Black Zinc	.029
3310	.285	.310	.875	.510	1/4-20	10-24	3/32	Black Zinc	.027
3311	.285	.310	.875	.510	5/16-18	10-24	3/32	Black Zinc	.026
3605	.285	.310	.875	.510	1/4-20	10-24	3/32	Stainless Steel	.027
3608	.285	.310	.875	.510	5/16-18	10-24	3/32	Stainless Steel	.026
3781	.285	.310	.875	.510	10-32	10-24	3/32	Bright Zinc	.029
3787	.285	.310	.875	.510	1/4-20	10-24	3/32	Bright Zinc	.028
3788	.285	.310	.875	.510	5/16-18	10-24	3/32	Bright Zinc	.026
3892	.285	.310	.875	.510	M5 x 0.80	M5	2.5MM	Bright Zinc	.029
3894	.285	.310	.875	.510	M8 x 1.25	M5	2.5MM	Bright Zinc	.025
3898	.285	.310	.875	.510	M6 x 1.00	M5	2.5MM	Bright Zinc	.026

☒ = 10 Series Compatible Part