

80/20® Inc.The *Industrial Erector Set®***THE STANDARD****Anchor Fasteners**

- One of 80/20®'s strongest fastening options
- Allows infinite positioning along a T-slotted profile
- Provides a vibration-proof, clean, flush connection where space restrictions apply
- Creates 90° connections where T-slots are in alignment
- Refer to page 567 for counterbore machining specifications
- Ships pre-assembled, saving you time *

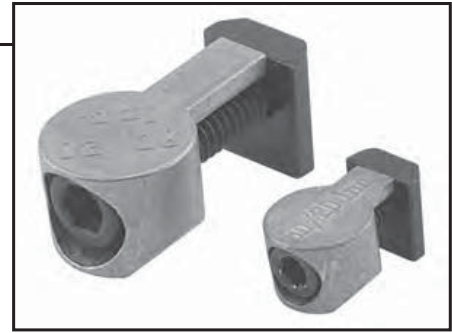

Part No.	Finish	Bolt Type	T-Nut Type	Lbs.
* 3395	Zinc Casting w/ Lacquer Finish	10-32 x.75"	Slide-In	.020
3896	Zinc Casting w/ Lacquer Finish	M5 x 18mm	Slide-In	.020
3363	Zinc Casting w/ Lacquer Finish	10-32 x.75"	Roll-In	.040
3665	Zinc Casting w/ Lacquer Finish	Stainless Steel 10-32 x.75"	Slide-In	.020
3391	Black Zinc Casting w/ Lacquer Finish	No bolt	N/A	.010
* 3392	Black Zinc Casting w/ Lacquer Finish	10-32 x.75"	Slide-In	.020
3396	Zinc Casting w/ Lacquer Finish	No Bolt	N/A	.010
* 3360	Zinc Casting w/ Lacquer Finish	5/16-18 x 1.3"	Slide-In	.100
3897	Zinc Casting w/ Lacquer Finish	M8 x 32mm	Slide-In	.100
3362	Zinc Casting w/ Lacquer Finish	5/16-18 x 1.3"	Roll-In	.100
3660	Zinc Casting w/ Lacquer Finish	Stainless Steel 5/16-18 x 1.25"	Slide-In	.100
3354	Black Zinc Casting w/ Lacquer Finish	No Bolt	N/A	.045
* 3359	Black Zinc Casting w/ Lacquer Finish	5/16-18 x 1.3"	Slide-In	.100
3361	Zinc Casting w/ Lacquer Finish	No Bolt	N/A	.045

= 10 Series Compatible Part

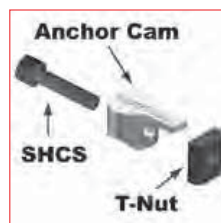
Anchor Fastener Assembly Steps**Step #1**

Anchor fasteners are composed of a socket head cap screw (SHCS), anchor cam and T-nut.

**Step #2**

Anchor fasteners ship pre-assembled. Slightly loosen the nut and bolt.

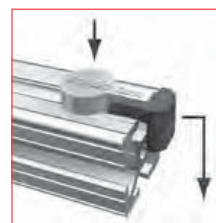
**Step #3**

Load the assembled anchor fastener into the counterbore hole. Be sure to position the T-nut with the offset hole oriented toward the top of the fastener. (See photo, Step #2)

**Step #4**

While holding the anchor fastener in the counterbore hole, slide the mating profile into place.

www.8020.net/anchor.asp**Step #5**

Square and align the mating profile. Using a T-handle hex wrench, tighten the SHCS in a clockwise motion until the profiles are securely affixed.

