



Series 3822

Direct Acting
2-Way & 3-Way

The Spartan Scientific Series 3822 is a metal body solenoid valve offered in both 2-Way & 3-Way, 2-Position Normally Closed or Normally Open functions and eight orifice sizes. Component features include the proven Series 3800 solenoid operator available in brass/stainless steel or all stainless steel pilot design, optional seal materials and Glass-Filled Nylon encapsulated coil in both DIN spade and flying lead. The "basket" orifice design feature allows the possibility of changing the orifice diameter to meet flow requirements within a matter of seconds. The rugged metal body coupled with the high cycle life, proven solenoid meet to make a solid solution for media and inert gas control. Available in all standard voltages, the valve saves energy while giving you the confidence of high quality in small envelope size.

Dimensional Data

ALL DIMENSIONS ARE IN INCHES UNLESS OTHERWISE NOTED

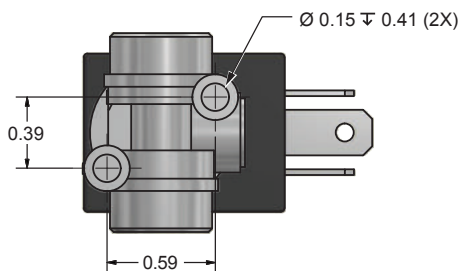
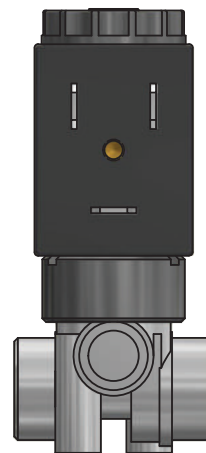
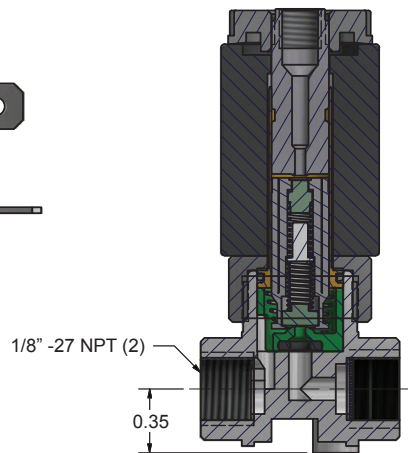
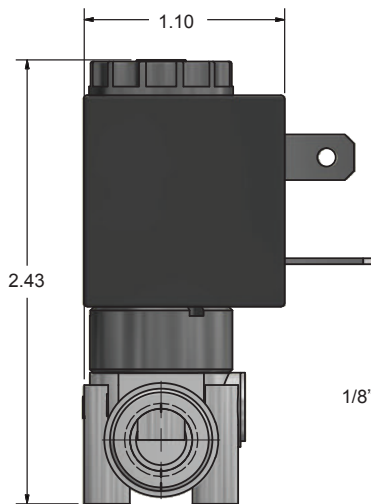
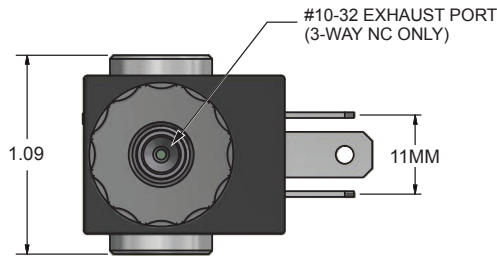

ORIFICE SIZE / VOLTAGE

FUNCTION	0.6mm		0.8mm		1.0mm		1.2mm		1.5mm		2.0mm		2.4mm		*3.0mm	
	AC	DC	AC	DC	AC	DC	AC	DC	AC	DC	AC	DC	AC	DC	AC	DC
2/2 NC	200	200	200	200	200	200	200	200	200	200	200	200	200	200	75	60
2/2 NO	N/A	N/A	N/A	N/A	N/A	N/A	N/A	N/A	150	150	N/A	N/A	N/A	N/A	N/A	N/A
3/2 NC	200	200	200	200	200	200	180	180	150	150	90	75	60	60	25	25
3/2 NO	N/A	N/A	N/A	N/A	N/A	N/A	N/A	N/A	150	150	N/A	N/A	N/A	N/A	N/A	N/A

MAX. PRESSURE RANGE (psi)

DIRECT ACTING



Series 3822

Direct Acting
2-Way & 3-Way

Technical Data

Function:	2-Way, 2-Position; Direct Acting; Normally Closed or Normally Open 3-Way, 2-Position; Direct Acting Normally Closed or Normally Open	Mounting:	#8 x 0.150" Self-Tapping Screw (2) not provided
Port Size:	1/8" NPT	Wetted Materials:	Elastomers: EPDM, FKM, NBR Operator: 300 and 400 Series Stainless Steel; or Brass Orifice Basket: APOM Shading Ring: Copper (AC only) Springs: 300 Series Stainless Steel Valve Body: Brass or Zamak
Orifice Size / Flow Factor:	0.6mm / 0.02 Cv 0.8mm / 0.03 Cv 1.0mm / 0.05 Cv 1.2mm / 0.06 Cv 1.5mm / 0.08 Cv 2.0mm / 0.17 Cv 2.4mm / 0.24 Cv 3.0mm / 0.31 Cv	Coil Data:	Duty Cycle: Continuous (within specifications) Encapsulation: Glass-Filled Nylon Insulation: Class F Power Rating: 6.5 Watt VDC, 8.5VA VAC (others available on request) Voltage: 12, 24 VDC 24, 120, 220, 240 VAC 50/60 Hz Voltage Tolerance: +/- 10% Nominal Winding: Class H
Pressure Range:	Vacuum to 200 psi (depending on orifice size and function)	Connections:	Spades: Terminals AMP 6.3x0.8 width 11mm (Available in DIN 43650 Form "A" / ISO 4400, EN175301-803:2006 for 3.0mm orifice or larger) Flying Lead: PVC 22 AWG, Multi-Strand Copper Wire, 300V, 12" minimum length
Temp. Range:	Fluid Max.: +90°C Dry Range: Ambient +10° to +50°C	Packaged Weight:	0.21 lbs.
Response Time:	12 to 14ms Complete Cycle		
Media:	Air, inert gas, light oil, water (contact factory for compatibilities)		
Environment Protection:	IP65 (IEC 144), NEMA 4 Dust-tight and water resistant (with electrical connector)		

DIRECT
ACTING

How To Order

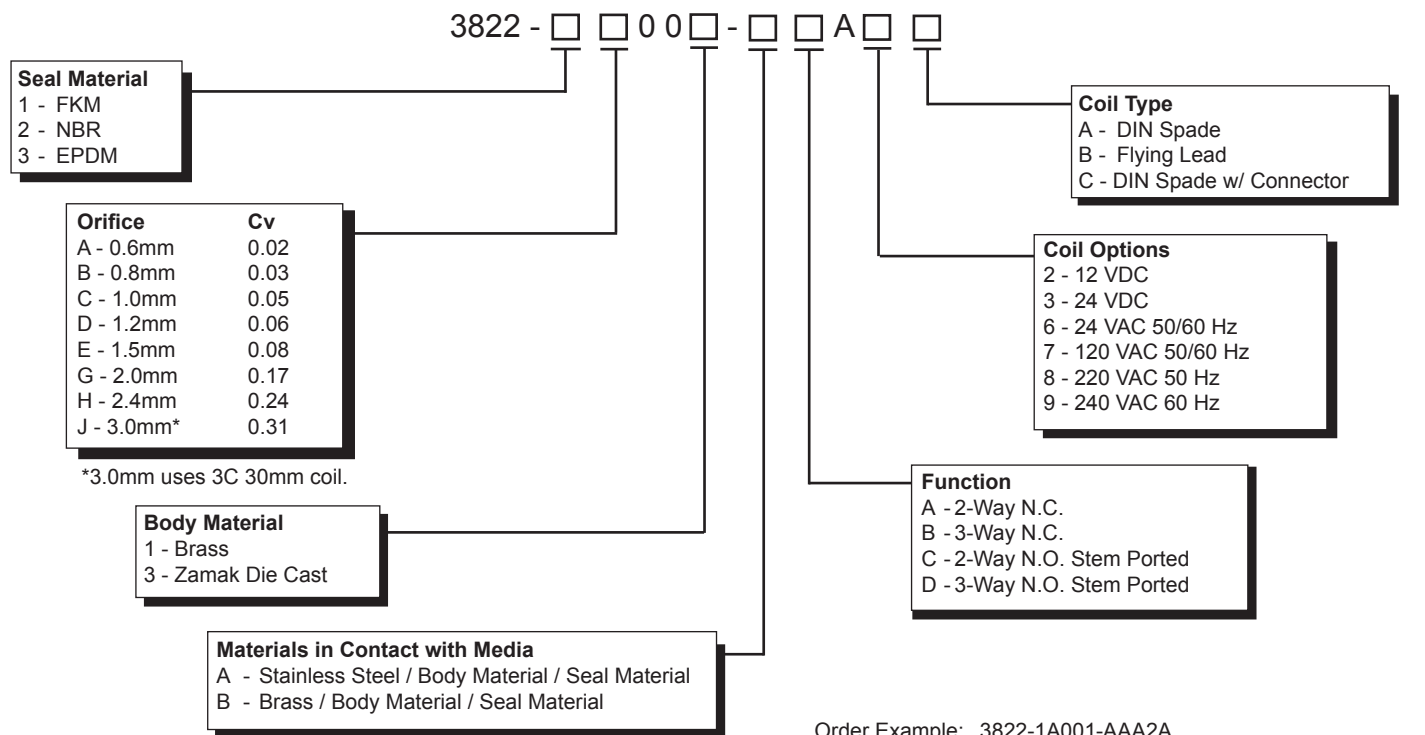

Order Example: 3822-1A001-AAA2A
FKM, 0.6mm orifice, 0.02 Cv, Brass,
Stainless Steel / Body Material / Seal Material,
2-Way N.C., 12 VDC, DIN Spade.