

# TAWI



TAWI MOBILE LIFTERS

# Mobile Order Picker

CE

## Mobile unit for efficient lifting and order picking



- Mobile vacuum lifter
- Easily attached to any forklift
- Quick start-up
- Stand-alone unit
- Integrated pump/battery
- Multiple tools for lifting anything from bags to laminate boards or tires

### Pick and lift anything, anywhere.

TAWI Mobile Order Picker offers a unique solution for order-picking from pallet racks, shelves or conveyors. Simply pick up the lifting unit with any kind of pallet jack or truck and drag or drive wherever you need to go.

A vacuum lifter on an articulating arm enables you to reach far into pallet racks or to the back wall of a container.

### Quick and easy to use

1. Attach TAWI Mobile Order Picker to any pallet jack or truck
2. Drive where you need to go
3. Park the unit and activate the vacuum pump with the push of a button. Support legs are automatically lowered.
4. Start loading/unloading your goods.



Integrated light panel facilitates work in dark spaces.



Support legs are automatically activated when the pump is started.



Battery and vacuum pump are integrated in the unit, protected by a robust cover.

## Handling all types of loads up to 175 lbs



Vacuum technology safely grips most types of loads without leaving any marks. TAWI's ergonomic handles are user-friendly and help ensure an efficient and ergonomic work environment.

With a wide selection of suction feet, you can easily find the tool needed to lift your goods. Need to lift more than one type of load? Add a quick coupling and easily switch between tools for various types of loads.

## Innovative design for safe and efficient operations

- **Robust cover** protecting battery and on-board electronics
- **User friendly** on-board control panel
- Internal air passage for **effortless operation**
- Electronically driven **height adjustment** to accommodate different lifting heights and height limitations
- **Adaptable fork tunnels** for effortless adjustment to any fork system
- **Safety lock** on articulating arm is automatically released when the pump is started
- Easily change battery pack for longer operational time, or connect to external power source

Adjustable height



## Technical drawings

Drawings on the following pages provide an overview of <sup>TAWI</sup> Mobile Order Picker in various perspectives. The table lists dimensions for the unit equipped with different vacuum lifter models. All measures are in millimeters.

	VM40	VM50	VM60	VM80	VC40
<b>A*</b>	150	149	132	156	130
<b>B</b>	1 340	1 320	1 320	1 290	1 230
<b>C*</b>	1 490	1 469	1 452	1 446	1 360
<b>D</b>	592	613	630	637	722
<b>E</b>	2 000	2 000	2 000	2 000	2 000
<b>F</b>	1 100	1 100	1 100	1 100	1 100
<b>G*</b>	2 000	2 000	2 000	2 000	2 000
<b>H*</b>	2 080	2 080	2 080	2 080	2 080
<b>I*</b>	1 850	1 850	1 850	1 850	1 850
<b>J</b>	1 150	1 150	1 150	1 150	1 150
<b>K</b>	1 710	1 710	1 710	1 710	1 710
<b>L</b>	1 100	1 100	1 100	1 100	1 100
<b>M</b>	1 130	1 130	1 130	1 130	1 130
<b>N</b>	470	470	470	470	470

\* +500 mm when tower is in elevated position.

### Side view

The below drawing shows the total height of the unit, the length of the articulating arm, the lifting height, and more.

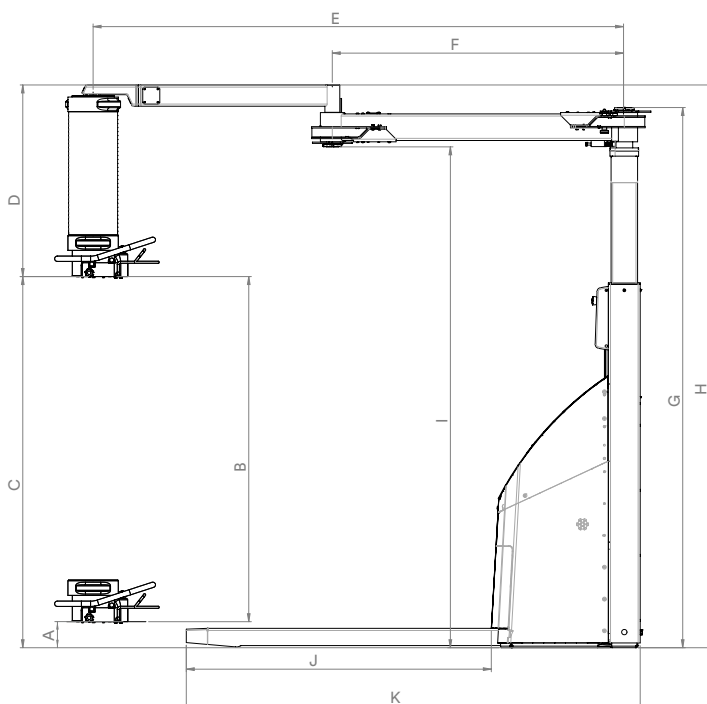

### Front view

The below drawing shows the lifting unit from the front, indicating the distance between attachment points for the lift arm (N).

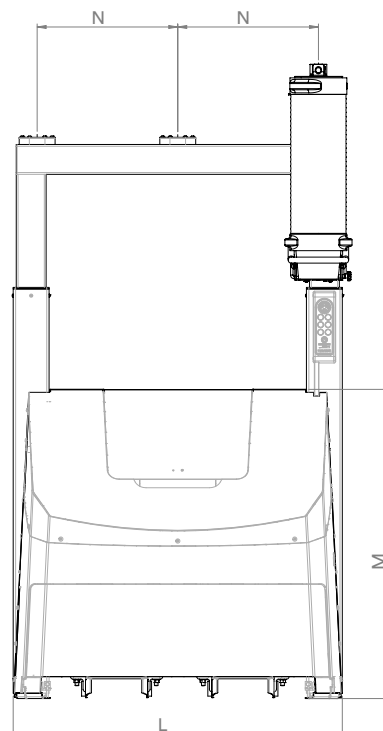

## Top view

This view illustrates the full range of motion achieved with the articulating arm.

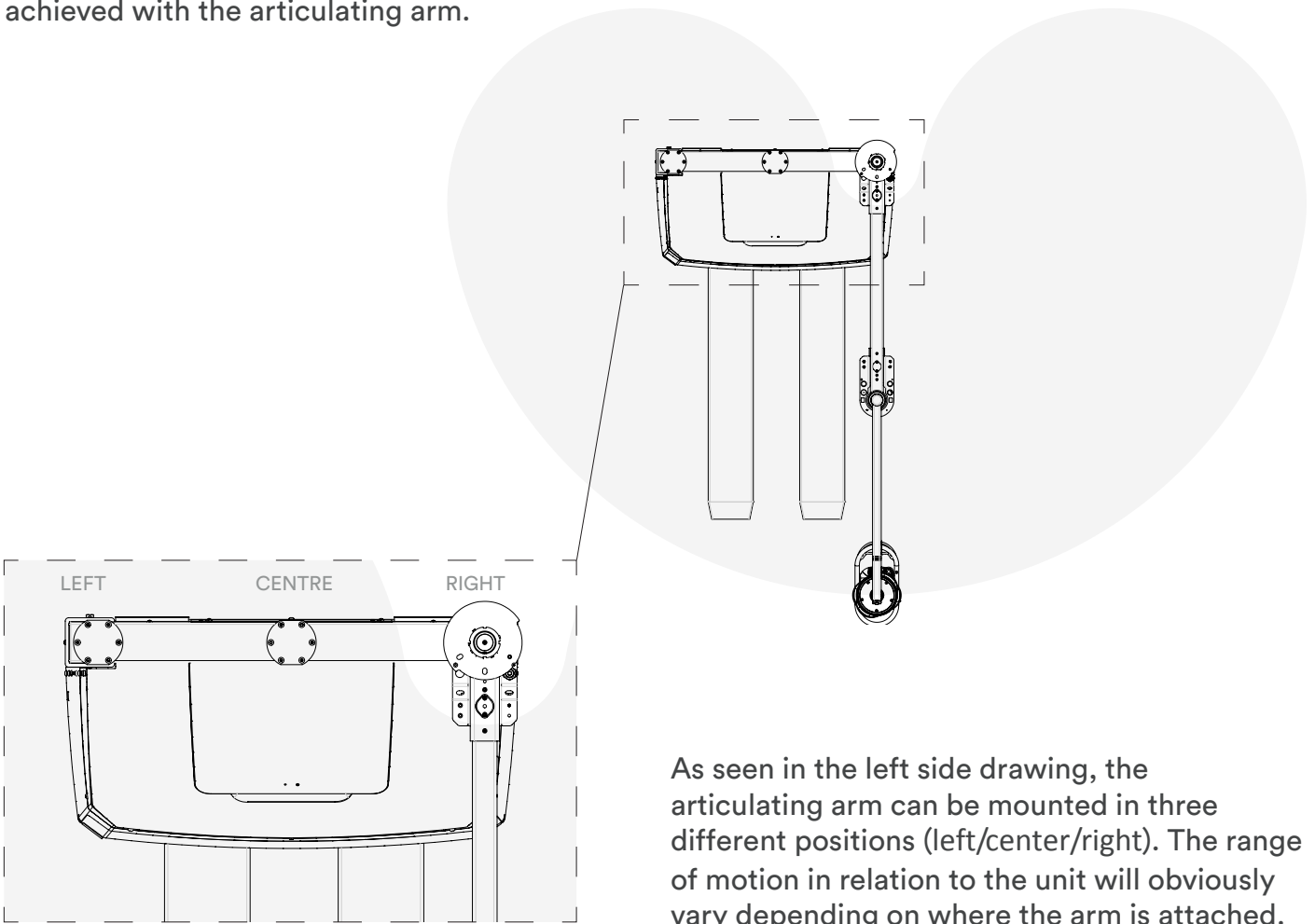

As seen in the left side drawing, the articulating arm can be mounted in three different positions (left/center/right). The range of motion in relation to the unit will obviously vary depending on where the arm is attached.

## Forks

Fork tunnels are adjustable to fit all types of fork lifts. See measures for both Euro- and US-forks in right side table and drawing below.

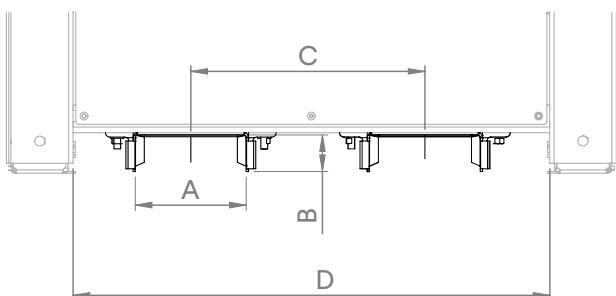

	<b>Euro</b>	<b>US</b>
<b>A</b>	200 mm	332 mm
<b>B</b>	65 mm	66 mm
<b>C</b>	315-535 mm	365-495 mm
<b>D</b>	860 mm	860 mm

## Technical specifications

	VM40	VM50	VM60	VM80	VC40
Lifting capacity	40 kg 88 lbs	50 kg 110 lbs	60 kg 132 lbs	80 kg 176 lbs	40 kg 88 lbs
Lift tube ø (mm)	120	140	160	180	120
Stroke vacuum lifter (mm)	1 340	1 320	1 320	1 290	1 230
Stroke tower (mm)	500	500	500	500	500
Lift tube length (mm)	1 750	1 750	1 750	1 700	1 600
Noise level, idle (dB)	76	76	76	76	76
Noise level, in operation (dB)	75	75	78	78	76
Max lifting height* with lowered tower (mm)	1 940 1 440	1 920 1 420	1 900 1 400	1 890 1 390	1 810 1 310
Battery charging procedure	Charger is 230v single-phase. Recommended 8 hours continuous charge.				
Battery pack replacement	Prolonged operational time is achieved by switching the battery pack. This procedure takes approx. 10 minutes.				
External power source	The unit can be connected to a 24 V external power source				
Up and down motions of tower	52-68 mm/s				
Weight of unit	1,388 lbs				

\*From bottom of suction head (excl. suction foot)

## TAWI ergonomic lifting solutions

Ergonomics is about adjusting work and work environments to the needs of the employees. It's about planning and organizing work in a way that contributes to healthy employees and minimizes the risk of injuries and long term health challenges. Good ergonomics is an effective way of making your business more productive and profitable

TAWI lifting equipment has been facilitating ergonomic material handling for decades, and by customizing our solutions to your specific needs we can guarantee that they will help lift your business.

Contact us for a free consultation.

[info.us@tawi.com](mailto:info.us@tawi.com)  
(630) 655-2905



MOBILE LIFTERS

CRANE SYSTEMS

HOISTS

VACUUM LIFTERS

VACUUM GRIPPERS

# TAWI

Smart lifting

Proud Members of the Following Associations:

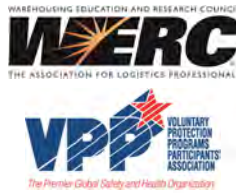

## USA:

TAWI USA  
380 Internationale Drive  
Suite A  
Bolingbrook, IL 60440  
Tel: +1 630-655-2905  
info.us@tawi.com

## Denmark:

TAWI DANMARK A/S  
Arresøvej 7  
DK-8240 Risskov  
Tel: +45 86 17 22 66  
mail@tawidanmark.d

## Germany:

TAWI GmbH  
August-Thyssen-Str. 1  
D-41564 Kaarst  
Tel: +49 211 20542740  
info@tawi.de

## Netherlands:

TAWI BV  
Postbus 6092  
5700 ET Helmond Houtse  
Parallelweg 34-35 5706 AB  
HELMOND  
Tel: +31 492-523705  
info@tawi.nl

## Headquarters Sweden:

TAWI AB  
Box 102 05  
434 23 Kungsbacka Tel:  
+46 300 185 00  
info@tawi.com

## United Kingdom:

TAWI UK Ltd  
Unit G, Pentagon Park,  
io Centre, Lodge Farm  
Northampton, NN57UW  
Tel:+44 1604 591120  
sales@tawi.co.uk

## France:

TAWI Levalair  
18 rue Denis Papin  
95250 Beauchamp Tel:  
+33 1 39 95 65 00  
info@levalair.fr

## Canada:

TAWI Canada Inc.  
15 West Pearce Street, Unit 3A  
Richmond Hill ON L4B 1H6  
Tel: +1 905 881 1633  
info.ca@tawi.com



Mobile Solutions

Crane Systems

Hoists

Vacuum Lifters

Vacuum Grippers