

## Economy Floor Mount Base Plate

# 80/20 Inc.

### Part Description:

The economy floor mount base plate is made of anodized aluminum to withstand daily use and wear and tear. It bolts directly to the T-slot to allow vertical adjustments and is designed with countersunk holes to incorporate floor anchors.

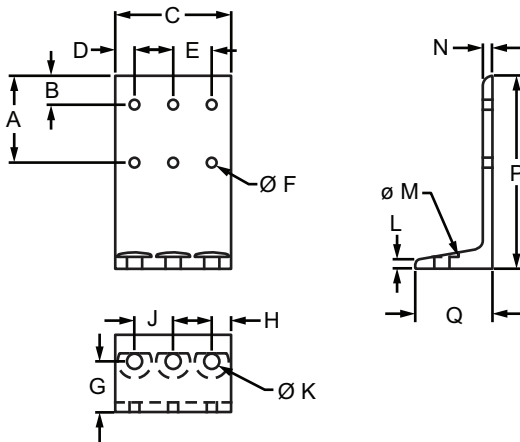

Part No.	Series	Color	A	B	C	D	E	F	G	H
2414	10	Clear	2.250"	.750"	1.000"	.500"	—	.257"	1.312"	.500"
2414-Black	10	Black	2.250"	.750"	1.000"	.500"	—	.257"	1.312"	.500"
2416	10	Clear	2.250"	.750"	2.000"	.500"	1.000"	.257"	1.312"	.500"
2416-Black	10	Black	2.250"	.750"	2.000"	.500"	1.000"	.257"	1.312"	.500"
2404	10	Clear	2.250"	.750"	3.000"	.500"	1.000"	.257"	1.312"	.500"
2404-Black	10	Black	2.250"	.750"	3.000"	.500"	1.000"	.257"	1.312"	.500"
2415	15	Clear	2.250"	.750"	1.500"	.750"	—	.328"	1.312"	.750"
2415-Black	15	Black	2.250"	.750"	1.500"	.750"	—	.328"	1.312"	.750"
2417	15	Clear	2.250"	.750"	3.000"	.750"	1.500"	.328"	1.312"	.750"
2417-Black	15	Black	2.250"	.750"	3.000"	.750"	1.500"	.328"	1.312"	.750"
2405	15	Clear	2.250"	.750"	4.500"	.750"	1.500"	.328"	1.312"	.750"
2405-Black	15	Black	2.250"	.750"	4.500"	.750"	1.500"	.328"	1.312"	.750"
			J	K	L	M	N	P	Q	Weight
2414	10	Clear	—	.390"	.312"	.875"	.250"	5.000"	2.000"	.178 lb
2414-Black	10	Black	—	.390"	.312"	.875"	.250"	5.000"	2.000"	.178 lb
2416	10	Clear	1.000"	.390"	.312"	.875"	.250"	5.000"	2.000"	.270 lb
2416-Black	10	Black	1.000"	.390"	.312"	.875"	.250"	5.000"	2.000"	.270 lb
2404	10	Clear	1.000"	.390"	.312"	.875"	.250"	5.000"	2.000"	.545 lb
2404-Black	10	Black	1.000"	.390"	.312"	.875"	.250"	5.000"	2.000"	.545 lb
2415	15	Clear	—	.531"	.312"	1.125"	.250"	5.000"	2.000"	.263 lb
2415-Black	15	Black	—	.531"	.312"	1.125"	.250"	5.000"	2.000"	.263 lb
2417	15	Clear	1.500"	.531"	.312"	1.125"	.250"	5.000"	2.000"	.545 lb
2417-Black	15	Black	1.500"	.531"	.312"	1.125"	.250"	5.000"	2.000"	.545 lb
2405	15	Clear	1.500"	.531"	.312"	1.125"	.250"	5.000"	2.000"	.785 lb
2405-Black	15	Black	1.500"	.531"	.312"	1.125"	.250"	5.000"	2.000"	.785 lb

CONTINUE



Part No.	Series	Color	A	B	C	D	E	F	G	H
25-2414	25	Clear	60.00mm	20.00mm	25.00mm	12.50mm	—	6.30mm	36.00mm	12.50mm
25-2414-Black	25	Black	60.00mm	20.00mm	25.00mm	12.50mm	—	6.30mm	36.00mm	12.50mm
25-2416	25	Clear	60.00mm	20.00mm	50.00mm	12.50mm	25.00mm	6.30mm	36.00mm	12.50mm
25-2416-Black	25	Black	60.00mm	20.00mm	50.00mm	12.50mm	25.00mm	6.30mm	36.00mm	12.50mm
40-2415	40	Clear	60.00mm	20.00mm	40.00mm	20.00mm	—	8.33mm	36.00mm	20.00mm
40-2415-Black	40	Black	60.00mm	20.00mm	40.00mm	20.00mm	—	8.33mm	36.00mm	20.00mm
40-2417	40	Clear	60.00mm	20.00mm	80.00mm	20.00mm	40.00mm	8.33mm	36.00mm	20.00mm
40-2417-Black	40	Black	60.00mm	20.00mm	80.00mm	20.00mm	40.00mm	8.33mm	36.00mm	20.00mm
			J	K	L	M	N	P	Q	Weight
25-2414	25	Clear	—	10.49mm	8.00mm	22.00mm	6.00mm	140.00mm	50.00mm	.0846 kg
25-2414-Black	25	Black	—	10.49mm	8.00mm	22.00mm	6.00mm	140.00mm	50.00mm	.0846 kg
25-2416	25	Clear	25.00mm	10.49mm	8.00mm	22.00mm	6.00mm	140.00mm	56.00mm	.1679 kg
25-2416-Black	25	Black	25.00mm	10.49mm	8.00mm	22.00mm	6.00mm	140.00mm	56.00mm	.1679 kg
40-2415	40	Clear	—	13.49mm	8.00mm	28.00mm	6.00mm	140.00mm	56.00mm	.1406 kg
40-2415-Black	40	Black	—	13.49mm	8.00mm	28.00mm	6.00mm	140.00mm	56.00mm	.1406 kg
40-2417	40	Clear	40.00mm	13.49mm	8.00mm	28.00mm	6.00mm	140.00mm	56.00mm	.2680 kg
40-2417-Black	40	Black	40.00mm	13.49mm	8.00mm	28.00mm	6.00mm	140.00mm	56.00mm	.2680 kg

### Material Specifications

Material	Alloy*	Process	Finish
Aluminum	6105-T5	Milled	Anodize

\* Or comparable

### Suggested Hardware (Mount to T-Slot)

Part No.	Series	Qty.	Bolt Assembly
3321	10	2 TO 6	1/4-20 x 1/2" FBHSCS & Economy T-Nut
3325	15	2 TO 6	5/16-18 x 3/4" Economy T-Slot Stud w/ Washer & Hex Nut
3320	15	2 TO 6	5/16-18 x 11/16" FBHSCS & Economy T-Nut
75-3412	25	2 TO 6	M6 x 12mm SHCS & Economy T-Nut
75-3500	40	2 TO 6	M8 x 20mm Economy T-Slot Stud w/ Washer & Hex Nut
75-3422	40	2 TO 6	M8 x 16mm BHSCS & Economy T-Nut

