

5 Hole - Center Tap Base Plate

80/20 Inc.

Part Description:

The 5 hole – center tap base plate is made of anodized aluminum to withstand daily use and wear and tear. It mounts leveling feet and threaded stem casters, and is commonly used on profiles to center mount a foot or caster. The 5 hole – center tap base plate can also be used on a profile side. It requires a tap (page 861) to mount to a profile end.

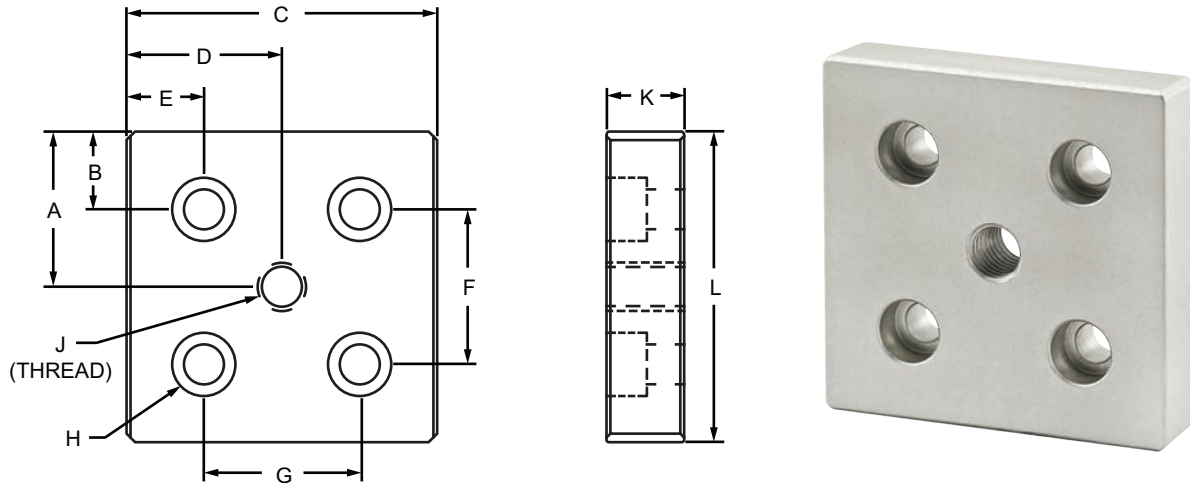

| Part No. | Series | Color | A | B | C | D | E | F | G | H | J | K | L | Weight |
|------------|--------|-------|--------|-------|--------|--------|-------|--------|--------|-----------|---------|-------|--------|---------|
| 2127 | 10 | Clear | 1.000" | .500" | 2.000" | 1.000" | .500" | 1.000" | 1.000" | 1/4 SHCS | 5/16-18 | .500" | 2.000" | .172 lb |
| 2127-Black | 10 | Black | 1.000" | .500" | 2.000" | 1.000" | .500" | 1.000" | 1.000" | 1/4 SHCS | 5/16-18 | .500" | 2.000" | .172 lb |
| 2131 | 10 | Clear | 1.000" | .500" | 2.000" | 1.000" | .500" | 1.000" | 1.000" | 1/4 SHCS | 3/8-16 | .500" | 2.000" | .169 lb |
| 2131-Black | 10 | Black | 1.000" | .500" | 2.000" | 1.000" | .500" | 1.000" | 1.000" | 1/4 SHCS | 3/8-16 | .500" | 2.000" | .169 lb |
| 2132 | 10 | Clear | 1.000" | .500" | 2.000" | 1.000" | .500" | 1.000" | 1.000" | 1/4 SHCS | 1/2-13 | .500" | 2.000" | .166 lb |
| 2132-Black | 10 | Black | 1.000" | .500" | 2.000" | 1.000" | .500" | 1.000" | 1.000" | 1/4 SHCS | 1/2-13 | .500" | 2.000" | .166 lb |
| 2139 | 10 | Clear | 1.000" | .500" | 2.000" | 1.000" | .500" | 1.000" | 1.000" | 1/4 SHCS | 7/16-14 | .500" | 2.000" | .168 lb |
| 2139-Black | 10 | Black | 1.000" | .500" | 2.000" | 1.000" | .500" | 1.000" | 1.000" | 1/4 SHCS | 7/16-14 | .500" | 2.000" | .168 lb |
| 2362 | 10 | Clear | 1.000" | .500" | 2.000" | 1.000" | .500" | 1.000" | 1.000" | 1/4 SHCS | 3/4-10 | .500" | 2.000" | .156 lb |
| 2362-Black | 10 | Black | 1.000" | .500" | 2.000" | 1.000" | .500" | 1.000" | 1.000" | 1/4 SHCS | 3/4-10 | .500" | 2.000" | .156 lb |
| 2140 | 15 | Clear | 1.500" | .750" | 3.000" | 1.500" | .750" | 1.500" | 1.500" | 5/16 SHCS | 1/2-13 | .750" | 3.000" | .604 lb |
| 2140-Black | 15 | Black | 1.500" | .750" | 3.000" | 1.500" | .750" | 1.500" | 1.500" | 5/16 SHCS | 1/2-13 | .750" | 3.000" | .604 lb |
| 2145 | 15 | Clear | 1.500" | .750" | 3.000" | 1.500" | .750" | 1.500" | 1.500" | 5/16 SHCS | 7/16-14 | .750" | 3.000" | .607 lb |
| 2145-Black | 15 | Black | 1.500" | .750" | 3.000" | 1.500" | .750" | 1.500" | 1.500" | 5/16 SHCS | 7/16-14 | .750" | 3.000" | .607 lb |
| 2366 | 15 | Clear | 1.500" | .750" | 3.000" | 1.500" | .750" | 1.500" | 1.500" | 5/16 SHCS | 3/4-10 | .750" | 3.000" | .588 lb |
| 2366-Black | 15 | Black | 1.500" | .750" | 3.000" | 1.500" | .750" | 1.500" | 1.500" | 5/16 SHCS | 3/4-10 | .750" | 3.000" | .588 lb |

CONTINUE



5 Hole - Center Tap Base Plate (Continued)

| Part No. | Series | Color | A | B | C | D | E | F | G | H | J | K | L | Weight |
|---------------|--------|-------|---------|---------|---------|---------|---------|---------|---------|---------|------------|---------|---------|----------|
| 25-2131 | 25 | Clear | 25.00mm | 12.50mm | 50.00mm | 25.00mm | 12.50mm | 25.00mm | 25.00mm | M6 SHCS | M10 x 1.50 | 12.00mm | 50.00mm | .0700 kg |
| 25-2131-Black | 25 | Black | 25.00mm | 12.50mm | 50.00mm | 25.00mm | 12.50mm | 25.00mm | 25.00mm | M6 SHCS | M10 x 1.50 | 12.00mm | 50.00mm | .0700 kg |
| 25-2132 | 25 | Clear | 25.00mm | 12.50mm | 50.00mm | 25.00mm | 12.50mm | 25.00mm | 25.00mm | M6 SHCS | M16 x 2.0 | 12.00mm | 50.00mm | .0700 kg |
| 25-2132-Black | 25 | Black | 25.00mm | 12.50mm | 50.00mm | 25.00mm | 12.50mm | 25.00mm | 25.00mm | M6 SHCS | M16 x 2.0 | 12.00mm | 50.00mm | .0700 kg |
| 25-2139 | 25 | Clear | 25.00mm | 12.50mm | 50.00mm | 25.00mm | 12.50mm | 25.00mm | 25.00mm | M6 SHCS | M12 x 1.75 | 12.00mm | 50.00mm | .0689 kg |
| 25-2139-Black | 25 | Black | 25.00mm | 12.50mm | 50.00mm | 25.00mm | 12.50mm | 25.00mm | 25.00mm | M6 SHCS | M12 x 1.75 | 12.00mm | 50.00mm | .0689 kg |
| 25-2362 | 25 | Clear | 25.00mm | 12.50mm | 50.00mm | 25.00mm | 12.50mm | 25.00mm | 25.00mm | M6 SHCS | M20 x 2.5 | 12.00mm | 50.00mm | .0630 kg |
| 25-2362-Black | 25 | Black | 25.00mm | 12.50mm | 50.00mm | 25.00mm | 12.50mm | 25.00mm | 25.00mm | M6 SHCS | M20 x 2.5 | 12.00mm | 50.00mm | .0630 kg |
| 40-2140 | 40 | Clear | 40.00mm | 20.00mm | 80.00mm | 40.00mm | 20.00mm | 40.00mm | 40.00mm | M8 SHCS | M12 x 1.75 | 19.00mm | 80.00mm | .3002 kg |
| 40-2140-Black | 40 | Black | 40.00mm | 20.00mm | 80.00mm | 40.00mm | 20.00mm | 40.00mm | 40.00mm | M8 SHCS | M12 x 1.75 | 19.00mm | 80.00mm | .3002 kg |
| 40-2145 | 40 | Clear | 40.00mm | 20.00mm | 80.00mm | 40.00mm | 20.00mm | 40.00mm | 40.00mm | M8 SHCS | M16 x 2.0 | 19.00mm | 80.00mm | .2950 kg |
| 40-2145-Black | 40 | Black | 40.00mm | 20.00mm | 80.00mm | 40.00mm | 20.00mm | 40.00mm | 40.00mm | M8 SHCS | M16 x 2.0 | 19.00mm | 80.00mm | .2950 kg |
| 40-2366 | 40 | Clear | 40.00mm | 20.00mm | 80.00mm | 40.00mm | 20.00mm | 40.00mm | 40.00mm | M8 SHCS | M20 x 2.5 | 19.00mm | 80.00mm | .2921 kg |
| 40-2366-Black | 40 | Black | 40.00mm | 20.00mm | 80.00mm | 40.00mm | 20.00mm | 40.00mm | 40.00mm | M8 SHCS | M20 x 2.5 | 19.00mm | 80.00mm | .2921 kg |

Material Specifications

| Material | Alloy* | Process | Finish |
|----------|---------|---------|---------|
| Aluminum | 6105-T5 | Milled | Anodize |

* Or comparable

Required Machining Services

| Machining Type | Machined | Reference Page |
|-----------------|------------------|----------------|
| Tap Profile End | Mounting Profile | 861 |

Suggested Hardware (Mount to T-Slot)

| Part No. | Series | Qty. | Bolt | T-Nut |
|----------|--------|------|---------------------|---------|
| 3491 | 10 | 4 | 1/4-20 x 1/2" SHCS | Economy |
| 3458 | 15 | 4 | 5/16-18 x 7/8" SHCS | Economy |
| 75-3412 | 25 | 4 | M6 x 12mm SHCS | Economy |
| 75-3430 | 40 | 4 | M8 x 20mm SHCS | Economy |

Suggested Hardware (Mount to Profile End)

| Part No. | Series | Qty. | Bolt |
|----------|--------|------|-----------------------|
| 3064 | 10 | 4 | 1/4-20 x 3/4" SHCS |
| 3123 | 15 | 4 | 5/16-18 x 1.25" SHCS |
| 13-6516 | 25 | 4 | M6 x 16mm SHCS (Blue) |
| 13-8525 | 40 | 4 | M8 x 25mm SHCS (Blue) |

